

1. Product Description

Polaris-W uses six warning light Leds and three floodlight Leds. It provides 120° lighting angle for consistent and even lighting effect in an extreme size of 45*45*19 mm. It uses more efficient TIR lens to meet daytime brightness using requirement. Unique 25° bevel design ensures a better large ground lighting effect. It has versatile installation methods: surface screw mount, bracket mount and hose clamp mount.

2. Technical Specifications

Product Name	Polaris-W
Max Power	13.5W
Voltage	DC 10-33V
Flash Pattern	10
IP Rating	IP67+IP69K
Operating Temperature	-30°C to +70°C
Dimensions	45*45*19mm (Bezel-free)
Certifications	ECE R65 Class 2 ECE R10, SAE J595, T13

www.911signal.com

Page 1

3. Product Introduction

3.1. Dimensions

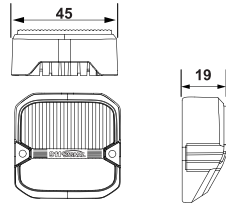

3.2. Floodlight Illumination Range

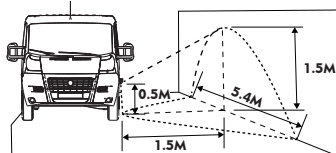

www.911signal.com

Page 2

3.3. Wirings

A. Function Wiring

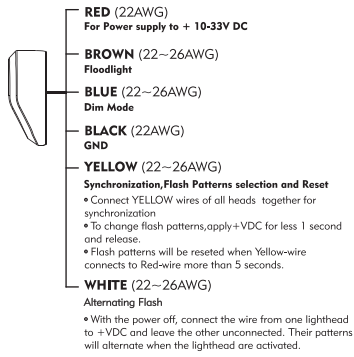

www.911signal.com

Page 3

B. Products Wiring

Pattern Synchronization

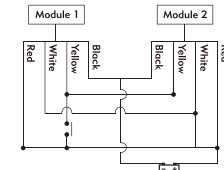

Pattern Alternation

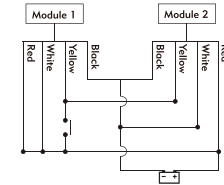

www.911signal.com

Page 4

4. Flash Patterns

1	Random (Default)	6	Quad (All)
2	ECE R65 Single (All)	7	Quint (All)
3	ECE R65 Double (All)	8	Ultra (All)
4	Single (All)	9	Single-Quad (All)
5	Double (All)	10	Single-H/L (All)

5. Mounting

5.1. Surface Mount

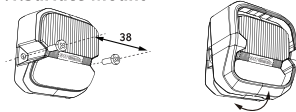

5.2. Optional Mounting Accessories

A. Bracket Mount (106301)

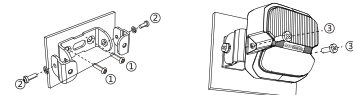

www.911signal.com

Page 5

B. Adjustable Hose Clamp Mount (106302)

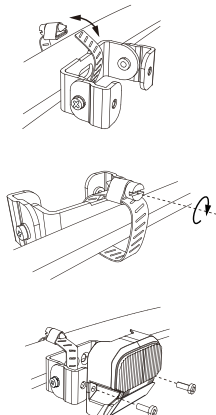

www.911signal.com

Page 6

911 Signal Technology Inc.

Manufacturer: Ningbo Yoso Intelligent Co., Ltd
Factory Address: Building 33, No. 136 Yuhai East Road,
Hangzhou Bay New District, Ningbo, Zhejiang, China
Tel: 0574-82822561
Email: sales@911signal.com
Website: www.911signal.com

B08PSX100003 V 1.0

911 SIGNAL



Polaris-W

Combination of
warning light and 120° floodlight

USER GUIDE