

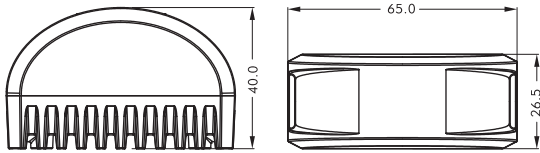

## CRESCENT

### Features

- > SAE, CA T13, ECE R65 and R10 certified
- > The most compact warning light to be certified under ECE R65 Class 2 regulations
- > Versatile mounting options with specially designed brackets
- > Solid and durable structure provides excellent weather resistance
- > Effective heat dissipation prolongs lifespan
- > IP69K rated



Mount with a cover

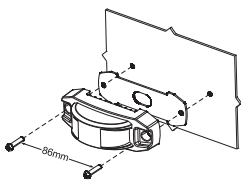

Mount with bracket

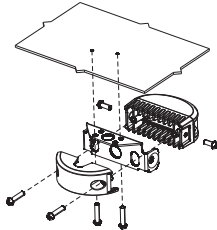

Mount with L-shaped brackets

L-shaped brackets are 360 degree rotatable.

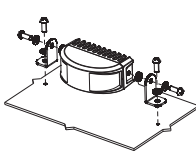

### Single Color

Item	Color	Voltage	Max Power	Lens	LED	Flash Patterns	Operating Temperature	Mounting
023602	<ul style="list-style-type: none"> <li>● Red</li> <li>● Blue</li> <li>● Yellow</li> <li>○ White</li> </ul>	10-33VDC	16W	TIR	8pcs 3W	12	-30 to 70°C	Surface Mount or Bracket Mount

### Dual Color

Item	Color	Voltage	Max Power	Lens	LED	Flash Patterns	Operating Temperature	Mounting
023601	<ul style="list-style-type: none"> <li>● Red/Blue</li> <li>● Red/Yellow</li> <li>● Blue/White</li> <li>● Yellow/White</li> </ul>	10-33VDC	16W	TIR	16pcs 3W	12	-30 to 70°C	Surface Mount or Bracket Mount

### 911 Signal Technology Inc.

China Office  
Tel: +86-574-89017911  
Fax: +86-574-82822560  
Email: sales@911signal.com

France Office  
Tel: +33(0)659163209  
Email: euoffice@911signalgroup.com  
www.911signal.com

